

WR - RASCHIATORI NBR 90



Tabella Dimensioni

CASTELLAN	dN	D	D1	H	L
CODE	mm	mm	mm	mm	mm
WR0120180	12,0	18,0	18,6	5,5	3,8
WR0130190	13,0	19,0	19,6		3,8
WR0140200	14,0	20,0	20,6		3,8
WR0150210	15,0	21,0	21,6	5,5	3,8
WR0160220	16,0	22,0	22,6	5,5	3,8
WR0170230	17,0	23,0	23,6		3,8
WR0180240	18,0	24,0	24,6	5,5	3,8
WR0180300	18,0	30,0	30,6	7,0	5,3
WR0190280	19,0	28,0	28,4	7,0	5,3
WR0200280	20,0	28,0	28,6	7,0	5,3
WR0220300	22,0	30,0	30,6	7,0	5,3
WR0240320	24,0	32,0	32,6	7,0	5,3
WR0250330	25,0	33,0	33,6	7,0	5,3
WR0260340	26,0	34,0	34,6		5,3
WR0270350	27,0	35,0	35,6	7,0	5,3
WR0280360	28,0	36,0	36,6	7,0	5,3
WR0300380	30,0	33,0	38,6	7,0	5,3
WR0320400	32,0	40,0	40,6	7,0	5,3
WR0330410	33,0	41,0	41,6		5,3
WR0330420	33,0	42,0	42,6	7,0	5,3
WR0350430	35,0	43,0	43,6	7,0	5,3
WR0350470	35,0	47,0	47,6	7,0	5,3
WR0350471	35,0	47,0	47,2	7,0	5,3
WR0360440	36,0	44,0	44,6	7,0	5,3
WR0380460	38,0	46,0	46,6	7,0	5,3
WR0400480	40,0	48,0	48,6	7,0	5,3
WR0400520	40,0	52,0	52,2	8,0	6,3
WR0420500	42,0	50,0	50,6	7,0	5,3
WR0450530	45,0	53,0	53,6	7,0	5,3
WR0450550	45,0	55,0	55,6	7,0	5,3
WR0460540	46,0	54,0	54,6	7,0	5,3
WR0480560	48,0	56,0	56,6	7,0	5,3

Movimento Alternativo
Velocità Max 1m/s

Metodo a Singolo Effetto / Temp -30°C + 80°C

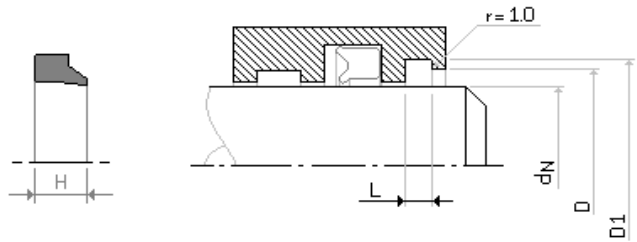
MATERIALE:
TPU (Poliuretano)

WR - RASCHIATORI NBR 90



Tabella Dimensioni

CASTELLAN	dN	D	D1	H	L
CODE	mm	mm	mm	mm	mm
WR0490570	49,0	57,0	57,6		5,3
WR0500580	50,0	58,0	58,6	7,0	5,3
WR0500600	50,0	60,0	60,6	7,0	5,3
WR0500601	50,8	60,0	60,9		5,8
WR0530610	53,0	61,0	61,6	7,0	5,3
WR0550630	55,0	63,0	63,6	7,0	5,3
WR0550650	55,0	65,0	65,6	7,0	5,3
WR0560640	56,0	64,0	64,6		5,3
WR0560660	56,0	66,0	66,6	7,0	5,3
WR0580680	58,0	68,0	68,6	7,0	5,3
WR0600680	60,0	68,0	68,6	7,0	5,3
WR0600700	60,0	70,0	70,6	7,0	5,3
WR0630710	63,0	71,0	71,6	7,0	5,3
WR0630730	63,0	73,0	73,6	7,0	5,3
WR0630750	63,0	75,0	75,2	9,0	6,3
WR0650730	65,0	73,0	73,6	7,0	5,3
WR0650750	65,0	75,0	75,6	7,0	5,3
WR0700720	70,0	72,0	76,0		4,3
WR0700780	70,0	78,0	78,6	7,0	5,3
WR0700800	70,0	80,0	80,6	7,0	5,3
WR0700820	70,0	82,0	82,6	12,0	7,2
WR0720800	72,0	80,0	80,6		5,3
WR0730810	73,0	81,0	81,6		5,3
WR0750830	75,0	83,0	83,6	7,0	5,3
WR0750850	75,0	85,0	85,6	7,0	5,3
WR0750870	75,0	87,0	87,2	12,0	7,2
WR0760880	76,5	88,0	88,7		7,1
WR0780920	78,0	92,0	92,2		7,1
WR0800880	80,0	88,0	88,6	7,0	5,3
WR0800920	80,0	92,0	92,6	12,0	7,2
WR0830910	83,0	91,0	91,6		5,3
WR0840910	84,0	91,7	92,3	7,0	5,3

Movimento Alternativo
Velocità Max 1m/s

Metodo a Singolo Effetto / Temp -30°C + 80°C

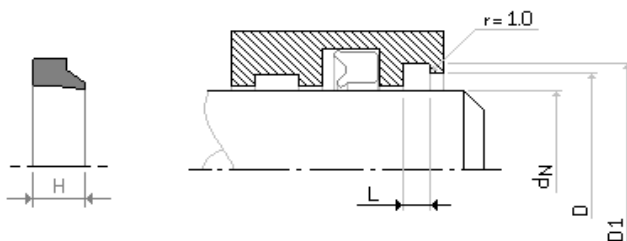
MATERIALE:
TPU (Poliuretano)

WR - RASCHIATORI NBR 90



Tabella Dimensioni

CASTELLAN	dN	D	D1	H	L
CODE	mm	mm	mm	mm	mm
WR0850930	85,0	93,0	93,6	7,0	5,3
WR0850970	85,0	97,0	97,2	12,0	7,2
WR0881000	88,0	100,0	100,2	12,0	7,2
WR0901000	90,0	100,0	100,6	12,0	7,2
WR0901020	90,0	102,0	102,2	12,0	7,2
WR0951030	95,0	103,0	103,6	7,0	5,3
WR0951070	95,0	107,0	107,2	12,0	7,2
WR0971110	97,0	111,0	111,2		7,1
WR1001080	100,0	108,0	108,6	7,0	5,3
WR1001120	100,0	112,0	112,2	12,0	7,2
WR1011110	101,0	111,0	111,2		5,3
WR1031150	103,0	115,0	155,2	12,0	7,2
WR1041160	104,0	116,0	166,2		7,1
WR1051170	105,0	117,0	117,2	12,0	7,2
WR1101180	110,0	118,0	118,6	7,0	5,3
WR1101220	110,0	122,0	122,2	12,0	7,2
WR1151230	115,0	123,0	123,2	7,0	5,3
WR1151250	115,0	125,0	125,6	7,0	5,3
WR1151270	115,0	127,0	127,2	12,0	7,2
WR1161280	116,0	128,0	128,2		7,1
WR1161300	116,0	130,0	130,2		7,1
WR1181300	118,0	130,0	130,2		7,1
WR1201280	120,0	128,0	128,6	7,0	5,3
WR1201320	120,0	132,0	132,2	12,0	7,2
WR1211250	121,0	125,0	131,0		5,3
WR1251330	125,0	133,0	133,6	7,0	5,3
WR1251370	125,0	137,0	137,2	12,0	7,2
WR1251400	125,0	140,0	140,0	16,0	10,2
WR1271350	127,0	135,0	135,6		5,3
WR1271390	127,0	139,0	139,2		7,1
WR1301420	130,0	142,0	142,2	12,0	7,2
WR1351470	135,0	147,0	147,2	12,0	7,2

Movimento Alternativo
Velocità Max 1m/s

Metodo a Singolo Effetto / Temp -30°C + 80°C

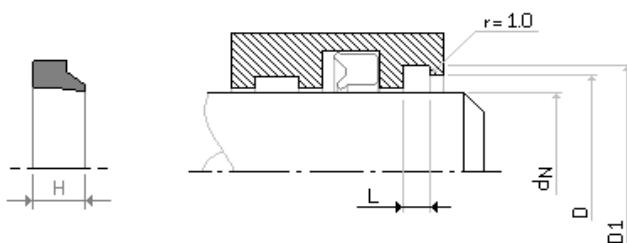
MATERIALE:
TPU (Poliuretano)

WR - RASCHIATORI NBR 90



Tabella Dimensioni

CASTELLAN	dN	D	D1	H	L
CODE	mm	mm	mm	mm	mm
WR1351490	135,0	149,0	149,2	12,0	7,2
WR1401520	140,0	152,0	152,2	12,0	7,1
WR1401550	140,0	155,0	155,6	16,0	10,2
WR1451570	145,0	157,0	157,2		7,1
WR1461580	146,0	158,0	158,0		6,3
WR1461581	146,1	158,0	158,3		7,1
WR1501620	150,0	162,0	162,2		7,1
WR1501650	150,0	165,0	165,6	16,0	10,2
WR1551670	155,0	167,0	167,2	12,0	7,2
WR1551690	155,0	169,0	169,2		7,1
WR1601750	160,0	175,0	175,6	16,0	10,2
WR1601680	160,0	168,0	168,6		5,3
WR1601750	160,0	175,0	175,2		10,1
WR1651730	165,0	173,0	173,6		5,3
WR1651770	165,0	177,0	177,2		7,1
WR1701800	170,0	180,0	180,6		5,3
WR1701820	170,0	182,0	182,2	12,0	7,2
WR1701850	170,0	185,0	185,2	16,0	10,2
WR1711830	171,0	183,0	183,0		6,3
WR1751890	175,0	189,0	189,2		7,1
WR1801950	180,0	195,0	195,2		10,1
WR1802000	180,0	200,0	200,0	18,0	10,2
WR1851970	185,0	197,0	197,0	12,0	7,2
WR1871950	187,0	195,0	195,6		5,3
WR1962100	196,0	210,0	210,2		7,1
WR1972190	197,0	219,0	219,0		6,3
WR2002150	200,0	215,0	215,2		10,1
WR2002200	200,0	220,0	220,0	18,0	10,2
WR2102240	210,0	224,0	224,2		7,1
WR2102250	210,0	225,0	225,0	16,0	10,2
WR2192330	219,5	233,0	233,7		7,1
WR2202400	220,0	240,0	240,0	18,0	10,2

Movimento Alternativo
Velocità Max 1m/s

Metodo a Singolo Effetto / Temp -30°C + 80°C

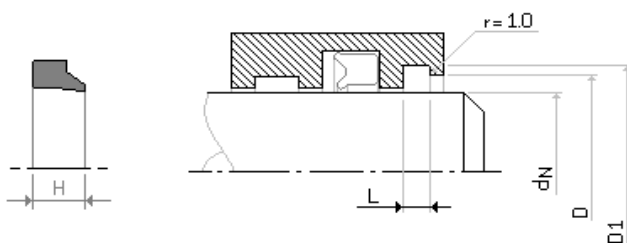
MATERIALE:
TPU (Poliuretano)

WR - RASCHIATORI NBR 90

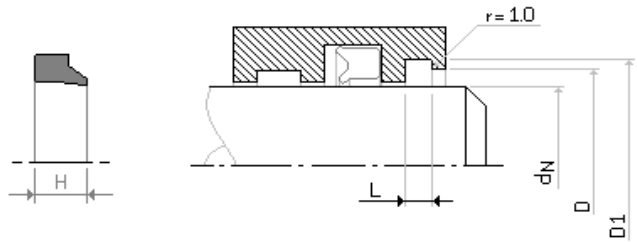

Tabella Dimensioni

CASTELLAN	dN	D	D1	H	L
CODE	mm	mm	mm	mm	mm
WR2232350	223,0	235,0	235,0		6,3
WR2402480	240,0	248,0	248,0	7,0	5,3
WR2402600	240,0	260,0	260,0	18,0	10,2
WR2442580	244,5	258,0	258,7		7,1
WR2492610	249,0	261,0	261,0		6,3
WR1502700	150,0	270,0	270,0	18,0	10,2
WR2602750	260,0	275,0	275,0		10,1
WR2602800	260	280	280	18	10,2
WR2803000	280	300	300	18	10,2
WR3003200	300	320	320	18	10,2
WR3603800	360	380	380	16	10,2