

E/GR - ANELLI TENUTE PISTONE



Tabella Dimensioni

CASTELLAN	Bore Dia.	Groove Dia.	Groove Width	O-Ring Dimension
CODE	DN H9	d1 h9	L1 + 0.2	
EG0080030	8,0	3,1	2,2	2,90 x 1,78
EG0100050	10,0	5,1	2,2	4,80 x 1,80
EG0110060	11,0	6,1	2,2	
EG0120070	12,0	7,1	2,2	6,70 x 1,80
EG0140090	14,0	9,1	2,2	8,75 x 1,80
EG0150070	15,0	7,5	3,2	7,59 x 2,62
EG0160080	16,0	8,5	3,2	7,59 x 2,62
EG0160110	16,0	11,1	2,2	10,82 x 1,78
EG0170120	17,0	12,1	2,2	
EG0180100	18,0	10,5	3,2	9,19 x 2,62
EG0180130	18,0	13,1	2,2	12,42 x 1,78
EG0190110	19,05	11,55	3,2	10,77 x 2,62
EG0200120	20,0	12,5	3,2	12,37 x 2,62
EG0200150	20,0	15,1	2,2	14,00 x 1,78
EG0210130	21,0	13,5	3,2	12,37 x 2,62
EG0220140	22,0	14,5	3,2	13,94 x 2,62
EG0220170	22,0	17,1	2,2	17,17 x 1,78
EG0240160	24,0	16,5	3,2	15,54 x 2,62
EG0250140	25,0	14,0	4,2	13,87 x 3,53
EG0250170	25,0	17,5	3,2	17,12 x 2,62
EG0250200	25,0	20,1	2,2	18,77 x 1,78
EG0250200	25,4	20,5	2,2	17,12 x 2,62
EG0270190	27,0	19,5	3,2	
EG0280170	28,0	17,0	4,2	
EG0280200	28,0	20,5	3,2	20,29 x 2,62
EG0280210	28,5	21,0	3,2	
EG0280211	28,58	21,08	3,2	
EG0300220	30,0	22,5	3,2	21,89 x 2,62
EG0320210	32,0	21,0	4,2	20,22 x 3,53
EG0320240	32,0	24,5	3,2	23,47x 2,62

E/GR - ANELLI TENUTE PISTONE

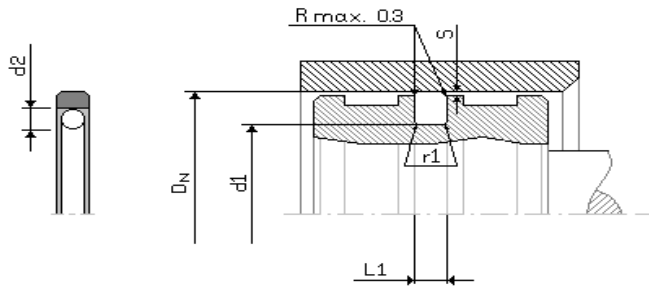

Tabella Dimensioni

CASTELLAN	Bore Dia.	Groove Dia.	Groove Width	O-Ring Dimension
CODE	DN H9	d1 h9	L1 + 0.2	
EG0320270	32,0	27,1	2,2	26,70 x 1,78
EG0350240	35,0	24,0	4,2	23,40 x 3,53
EG0350270	35,0	27,5	3,2	26,64 x 2,62
EG0360280	36,0	28,5	3,2	28,24 x 2,62
EG0380300	38,0	30,5	3,2	29,82 x 2,62
EG0390310	39,0	31,5	3,2	
EG0400290	40,0	29,0	4,2	28,17 x 3,53
EG0400320	40,0	32,5	3,2	31,42 x 2,62
EG0420310	42,0	31,0	4,2	29,75 x 3,53
EG0440370	44,5	37,0	3,2	36,17 x 2,62
EG0450340	45,0	34,0	4,2	32,92 x 3,53
EG0480370	48,0	37,0	4,2	36,09 x 3,53
EG0490380	49,0	38,0	4,2	
EG0500340	50,0	34,5	6,3	32,69 x 5,33
EG0500390	50,0	39,0	4,2	37,70 x 3,53
EG0500420	50,0	42,5	3,2	40,94 x 2,62
EG0500391	50,8	39,8	4,2	37,70 x 3,53
EG0500430	50,8	43,3	3,2	42,52 x 2,62
EG0520410	52,0	41,0	4,2	40,87 x 3,53
EG0530420	53,0	42,0	4,2	40,87 x 3,53
EG0550390	55,0	39,5	6,3	
EG0550440	55,0	44,0	4,2	44,04 x 3,53
EG0560450	56,0	45,0	4,2	
EG0570460	57,0	46,0	4,2	44,04 x 3,53
EG0580470	58,0	47,0	4,2	47,22 x 3,53
EG0600440	60,0	44,5	6,3	
EG0600490	60,0	49,0	4,2	47,22 x 3,53
EG0620510	62,0	51,0	4,2	50,39 x 3,53
EG0630470	63,0	47,5	6,3	46,99 x 5,33
EG0630520	63,0	52,0	4,2	50,39 x 3,53

Movimento Alternativo (Max 800 bar)
Velocità Max 15m/s

Metodo a Semplice Effetto / Temp -45°C + 200°C

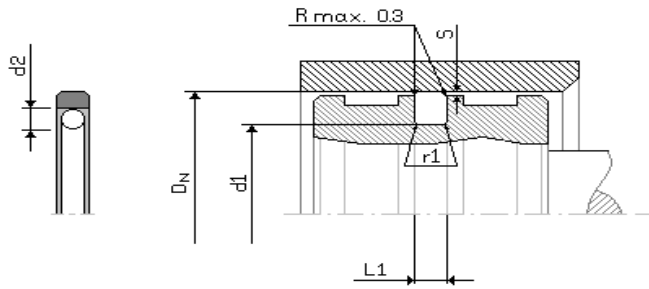
MATERIALE:
PTFE Bronzo/OR NBR

E/GR - ANELLI TENUTE PISTONE



Tabella Dimensioni

CASTELLAN	Bore Dia.	Groove Dia.	Groove Width	O-Ring Dimension
CODE	DN H9	d1 h9	L1 + 0.2	
EG0640530	64,0	53,0	4,2	
EG0650540	65,0	54,0	4,2	53,57 x 3,53
EG0680570	68,0	57,0	4,2	56,74 x 3,53
EG0690580	69,8	58,8	4,2	
EG0700540	70,0	54,5	6,3	53,34 x 5,33
EG0700590	70,0	59,0	4,2	56,74 x 3,53
EG0720610	72,0	61,0	4,2	60,33 x 3,53
EG0740630	74,0	63,0	4,2	61,91 x 3,53
EG0750590	75,0	59,5	6,3	56,52 x 3,53
EG0750640	75,0	64,0	4,2	63,09 x 3,53
EG0800590	80,0	59,0	8,1	58 x 7,0
EG0800640	80,0	64,5	6,3	62,87 x 5,33
EG0800690	80,0	69,0	4,2	66,27 x 3,53
EG0820710	82,0	71,0	4,2	
EG0820670	82,5	67,0	6,3	66,04 x 5,33
EG0850640	85,0	64,0	8,1	63 x 7,0
EG0850690	85,0	69,5	6,3	69,22 x 5,33
EG0860700	86,0	70,5	6,3	69,22 x 5,33
EG0880720	88,0	72,5	6,3	
EG0900690	90,0	69,0	8,1	68X7,0
EG0900740	90,0	74,5	6,3	72,39 x 5,33
EG0950840	95,0	84,0	4,2	82,14 x 3,53
EG0950740	95,0	74,0	8,1	73 x 7,0
EG0950790	95,0	79,5	6,3	78,74 x 5,33
EG1000790	100,0	79,0	8,1	78 x 7,0
EG1000840	100,0	84,5	6,3	81,92 x 5,33
EG1000890	100,0	89,0	4,2	88,49 x 3,53
EG1010860	101,6	86,1	6,3	85,09 x 5,33
EG1050840	105,0	84,0	8,1	
EG1050890	105,0	89,5	6,3	88,27 x 5,33

Movimento Alternativo (Max 800 bar)
Velocità Max 15m/s

Metodo a Semplice Effetto / Temp -45°C + 200°C

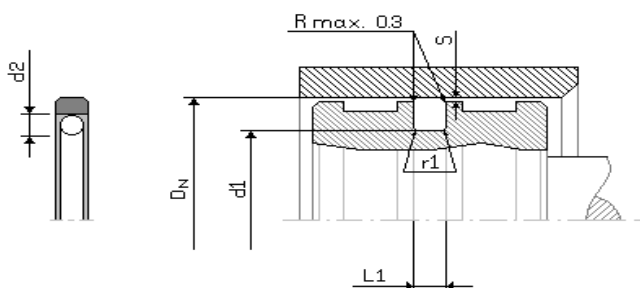
MATERIALE:
PTFE Bronzo/OR NBR

E/GR - ANELLI TENUTE PISTONE



Tabella Dimensioni

CASTELLAN	Bore Dia.	Groove Dia.	Groove Width	O-Ring Dimension
CODE	DN H9	d1 h9	L1 + 0.2	
EG1050940	105,0	94,0	4,2	91,67 x 3,53
EG1080920	108,0	92,5	6,3	91,44 x 5,33
EG1100890	110,0	89,0	8,1	88 x 7,0
EG1100940	110,0	94,5	6,3	91,44 x 5,33
EG1100990	110,0	99,0	4,2	98,02 x 3,53
EG1140980	114,3	98,8	6,3	
EG1150940	115,0	94,0	8,1	
EG1150990	115,0	99,5	6,3	97,79 x 5,33
EG1200990	120,0	99,0	8,1	98 x 7,0
EG1201040	120,0	104,5	6,3	100,97 x 5,33
EG1201090	120,0	109,0	4,2	107,54 x 3,53
EG1251040	125,0	104,0	8,1	103 x 7,0
EG1251090	125,0	109,5	6,3	107,32 x 5,33
EG1251140	125,0	114,0	4,2	113,89 x 3,53
EG1271110	127,0	111,5	6,3	110,49 x 5,33
EG1301090	130,0	109,0	8,1	108 x 7,0
EG1301140	130,0	114,5	6,3	113,67 x 5,33
EG1321110	132,0	111,0	8,1	
EG1321210	132,0	121,0	4,2	120,24 x 3,53
EG1331120	133,0	112,0	8,1	
EG1351140	135,0	114,0	8,1	113,67 x 7,0
EG1401190	140,0	119,0	8,1	116,84 x 7,0
EG1451240	145,0	124,0	8,1	123,19 x 7,0
EG1501290	150,0	129,0	8,1	126,37 x 7,0
EG1551340	155,0	134,0	8,1	132,72 x 7,0
EG1601390	160,0	139,0	8,1	135,89 x 7,0
EG1601440	160,0	144,5	6,3	142,24 x 5,33
EG1651440	165,0	144,0	8,1	142,24 x 7,0
EG1701490	170,0	149,0	8,1	145,42 x 7,0
EG1701540	170,0	154,5	6,3	

Movimento Alternativo (Max 800 bar)
Velocità Max 15m/s

Metodo a Semplice Effetto / Temp -45°C + 200°C

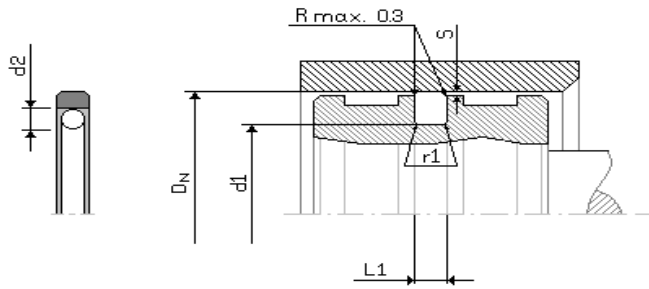
MATERIALE:
PTFE Bronzo/OR NBR

E/GR - ANELLI TENUTE PISTONE

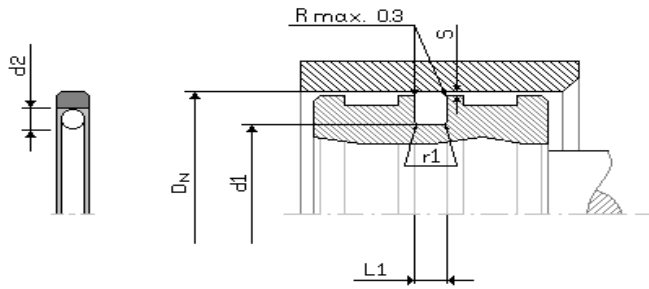

Tabella Dimensioni

CASTELLAN	Bore Dia.	Groove Dia.	Groove Width	O-Ring Dimension
CODE	DN H9	d1 h9	L1 + 0.2	
EG1751540	175,0	154,0	8,1	151,77 x 7,0
EG1751590	175,0	159,5	6,3	
EG1801590	180,0	159,0	8,1	158,12 x 7,0
EG1801640	180,0	164,5	6,3	164,47 x 5,33
EG1901690	190,0	169,0	8,1	164,47 x 7,0
EG1901740	190,0	174,5	6,3	
EG2001790	200,0	179,0	8,1	177,17 x 7,0
EG2001840	200,0	184,5	6,3	183,52 x 5,33
EG2051840	205,0	184,0	8,1	183,52 x 7,0
EG2101890	210,0	189,0	8,1	183,52 x 7,0
EG2151940	215,0	194,0	8,1	189,87 x 7,0
EG2201990	220,0	199,0	8,1	196,22 x 7,0
EG2302090	230,0	209,0	8,1	202,57 x 7,0
EG2402190	240,0	219,0	8,1	215,27 x 7,0
EG2502290	250,0	229,0	8,1	227,97 x 7,0
EG2602390	260,0	239,0	8,1	240,67 x 7,0
EG2802590	280,0	259,0	8,1	253,37 x 7,0
EG2902690	290,0	269,0	8,1	266,07 x 7,0
EG3002790	300,0	279,0	8,1	278,77 x 7,0

All dimensions in **bold** type are suitable for installation in grooves to ISO 7425/1, bore dia. In accordance with ISO 3320.
Other dimensions and all intermediate sizes up to 2700mm dia. Including inch sizes can be supplied.